

Dimensional drawing

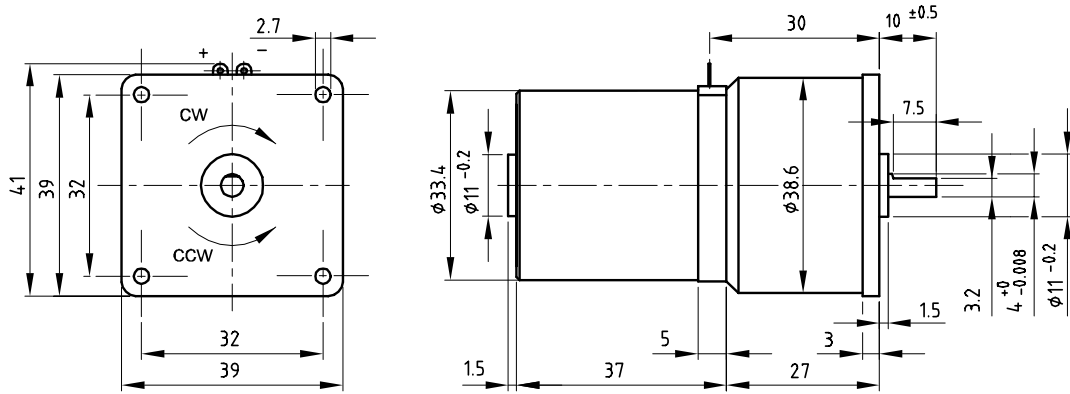

Gear Motor data

Gear motor Order number		Gear ratio	Direction of rotation	Nominal voltage [V]	Maximal voltage [V]	Maximum torque continuous [Nm] (nominal load)	Maximum torque intermittent [Nm]	Speed at no load [rpm]	Speed at nominal load [rpm]	Current at no load [mA]	Current at nominal load [mA]	Maximal radial force [N]	Maximal axial force [N]
9904 120 53 +	406	81:1	CW	6	7.2	0.24	0.48	47.3	32.9	103	460	6	6
	606			12	14.4			45.3	35.6	48	215		
	706			24	28.8			45.4	35.8	24	108		
	407	150.4:1	CCW	6	7.2	0.45	0.8	25.5	16.8	103	502	8	8
	607			12	14.4			24.4	18.5	48	234		
	707			24	28.8			24.4	18.6	24	118		
	408	243:1	CCW	6	7.2	0.6	0.8	15.8	11.3	103	434	8	8
	608			12	14.4			15.1	12.1	48	204		
	708			24	28.8			15.1	12.2	24	101		
	409	451.25:1	CW	6	7.2	0.6	0.8	8.5	7.1	103	300	10	10
	609			12	14.4			8.1	7.1	48	140		
	709			24	28.8			8.1	7.2	24	70		
	411	729:1	CW	6	7.2	0.6	0.8	5.3	4.7	103	225	10	10
	611			12	14.4			5.0	4.6	48	105		
	711			24	28.8			5.0	4.7	24	53		

Motor data

	Nominal Voltage [V]	Rotor resist. [Ohm]	Speed at no load [rpm]	Stall torque [mNm]	Torque const. [mNm/A]
9904 120 534..	6	3.6	3800	23	14
9904 120 536..	12	15	3550	23	30
9904 120 537..	24	58	3550	23	61

General data

*	Type of bearings	sleeve	
*	Commutation system	graphite / copper	
*	Gear material	plastic / metal	
*	Axial play	0.5	mm
*	Ambient temp. range operating	-20/+60	°C
*	Ambient temp. range storage	-40/+70	°C
*	Thermal resistance winding-ambient	30	K/W
*	Mass of gear motor	125	g

Options

- * Special shafts
- * Other supply voltage